

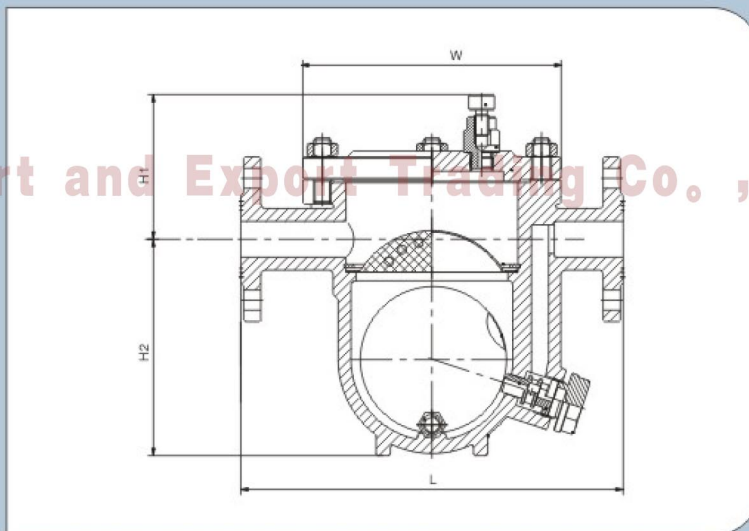

CS41H



### 工作原理 Working principle

本产品根据浮力的原理，使阀体内的浮球随水位变化做升降运动，以达到阀门启闭，即排水阻汽的作用。

According to the principle of buoyancy, this product makes the ball in the valve body up and down with the change of water level, so as to open or close the valve, which works as draining the water and preventing the steam.

### 结构特点 Structure characteristics

1. 能连续排水、性能稳定、排水量大、漏气量少。
  2. 能连续饱和水，致使设备凝结水滞存量较少、升温快、加热温度稳定。
  3. 有自动排冷空气装置，无气锁现象，工作平衡无噪音。
- 1.It can drain water continuously and perform in a stable way with large capacity and less steam loss.
- 2.It can saturate the water continuously, which makes less stock of condensation water in the equipment and is quick in heating and stable in heating temperature.
- 3.It has automatic cold air vent device without air lock situation. It works in balanced way without noisy.

### 外形参数 Specification

产品型号 Product model	口径Size(DN)	连接方式 Connection Type	最高允许温度℃ Max. allowable temp.℃	阀体材质 Material of valve body	尺寸dimension				
					L	L加长1 L+long@preferred	H1	H2	W
16C CS41H-25C-B 40C	15	法兰Flange	350	WCB	195	210	94.5	107	132
	20	法兰Flange	350	WCB	195	210	97	104.5	132
	25	法兰Flange	350	WCB	215	230	101.5	111.5	140
CS11H-64-B	15-25	法兰Flange	350	WCB	250		115	105	
	32-50	法兰Flange	350	WCB	350		120	210	
16C CS41H-25C-D 40C	25	法兰Flange	350	WCB	270		102.5	151	180
	32	法兰Flange	350	WCB	270	280	109	154.5	180
	40	法兰Flange	350	WCB	280		112	170	184
	50	法兰Flange	350	WCB	290	320	117	175	195

